

**LEGEND**

- SITE OWNERSHIP BOUNDARY
- EXISTING BUILDING TO BE DEMOLISHED  
2191m<sup>2</sup>

**AREA**

Ground Floor Area	2434m <sup>2</sup>
First Floor Area	1191m <sup>2</sup>
Combined Demolition	3625m <sup>2</sup>

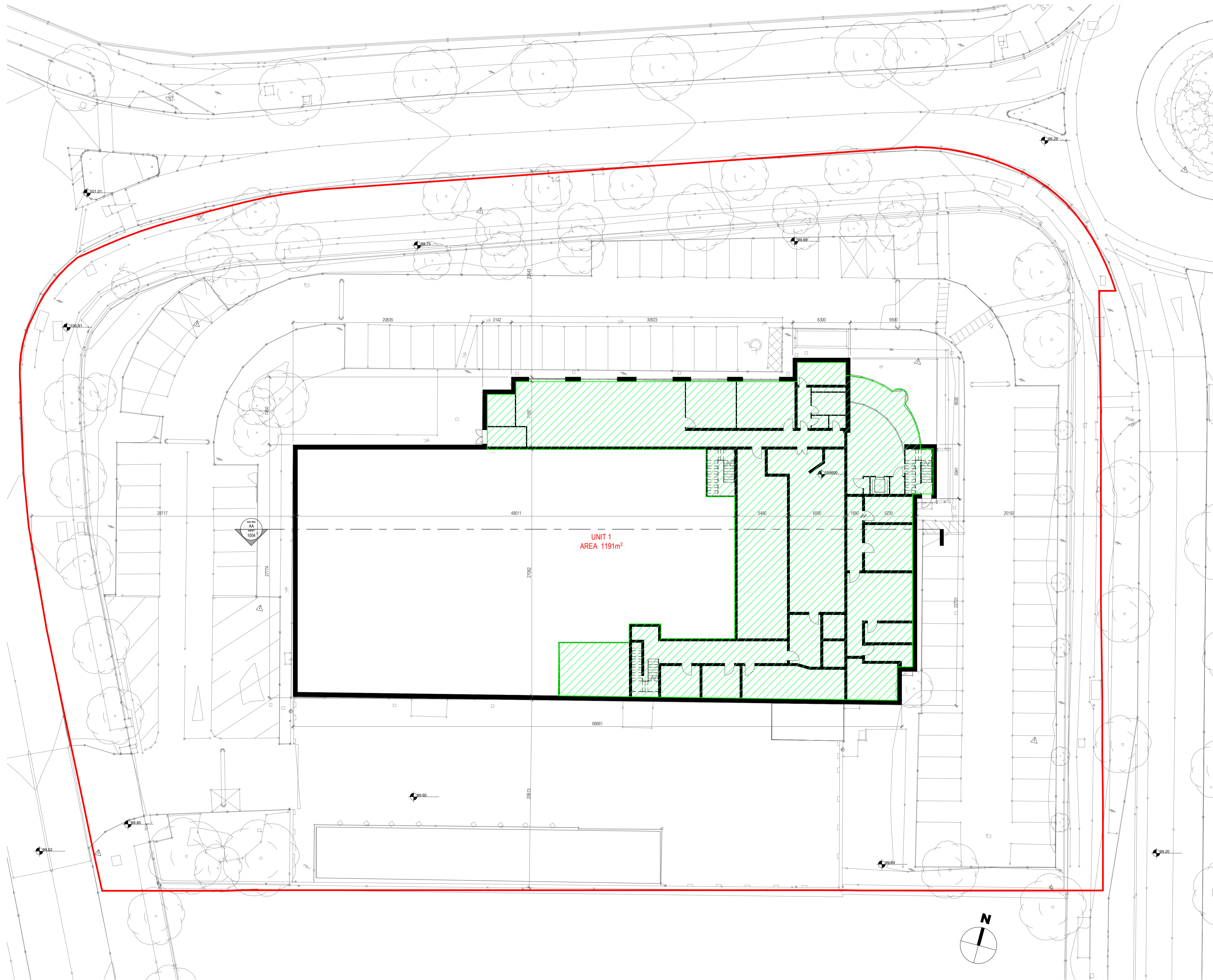

REV	DATE	SIGNED	NOTES
P01	12/05/2022	SOD	Issued for SHD Application

Project Stage

SHD Application

Client

Landmarque Property Group Ltd

Project

Belgard Rd, Tallaght

Drawing Title

PROPOSED DEMOLITION FIRST FLOOR PLAN

Drawn	Checked	Scale @ A1	As	Date
AB	SOD		indicated	03/29/21

Project No.	Drawing No.
19-150	1003

Drawing BIM Name:

PE19150-CWO-ZZ-01-DR-A-1003

CDE Area	Suitability Code	BIM Revision
		P01



1 Sarsfield Quay, Arbour Hill, Dublin 7  
t: 01 518 0170 e: admin@cw architects.ie  
Dublin | London | Warwick | Manchester  
www.cw architects.ie